



CONSOLE VAULT®

THE ORIGINAL IN-VEHICLE SAFE™

800-878-1369 www.consolevault.com

CV LED Light Instruction Sheet (8401)



Installation Steps:

Note: You need to ensure that the area where the lock latches to the frame is clear of objects before beginning the installation procedure.

1. Remove the plastic battery tab from the assembly (**Image 1.1**). The lights should turn on (**Image 1.2**).

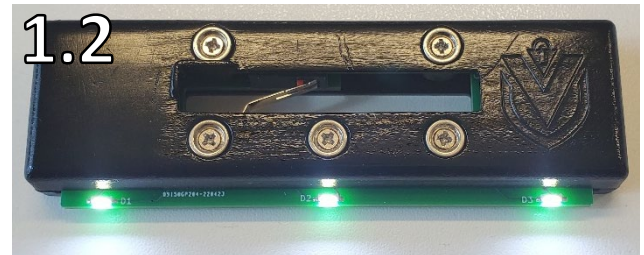
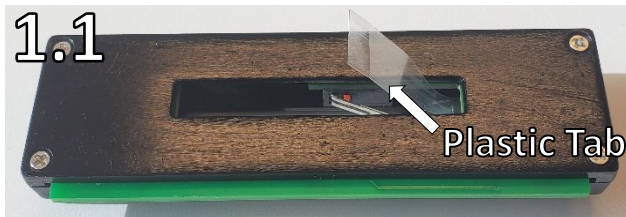

2. Place the CV LED behind the triple guard with the LED's pointing downwards and the magnets are facing the back of the triple guard (**Image 2**).

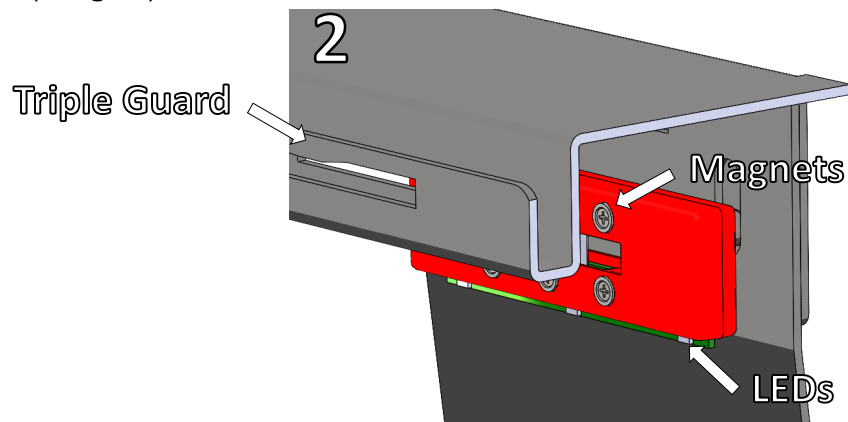

3. Attach the CV LED to the back of the triple guard with the magnets. Ensure that the L shaped locating feature is in the back hole of the triple guard and slid all the way to the left (**Image 3**).

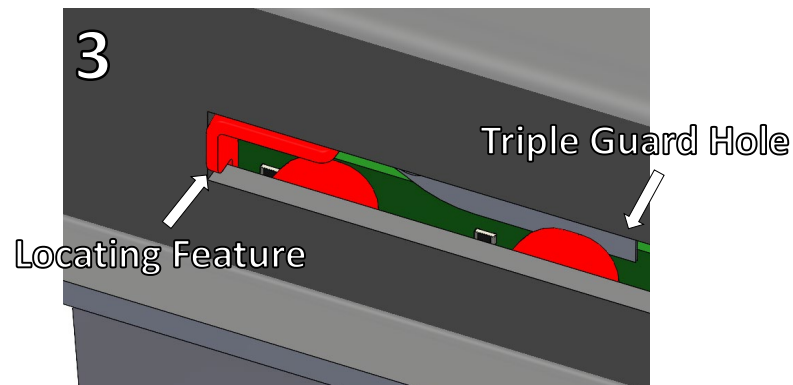

4. Close and lock the console, ensuring that the LED light turns off.

Battery Replacement

Replacement Steps:

1. Remove the LED from the safe (**Image 1**).

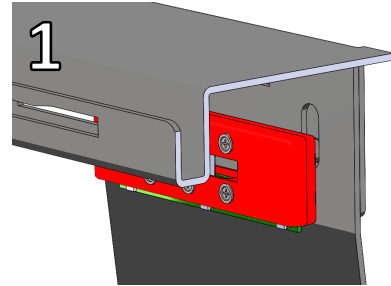

2. Remove the 4 screws on the back of the LED unit. (**Image 2**).



3. Remove the PCB from the case and replace the 2 CR2032 batteries. (**Image 3**).

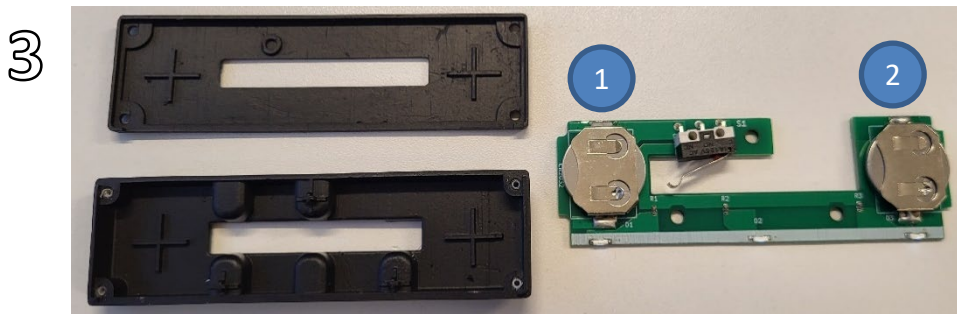

4. Place the PCB back in the case and secure the 4 screws. (**Image 3**).



5. Re-install the LED unit as per the installation instructions.

Cam Replacement (ELITE LOCK ONLY)



Installation Steps:

Note: Replace the cam **ONLY** if you have an Elite Lock as pictured above. Other locks do not require you to change the cam.

1. Move lock to the unlocked position (**image 1.1**). Remove the screw and the cam on the bottom of the Elite Lock (**image 1.2**).



2. Locate the "CV" logo on the new cam (**image 2.1**). Attach the new cam to the Elite lock, ensure that the CV logo is facing the lid (**image 2.2**).

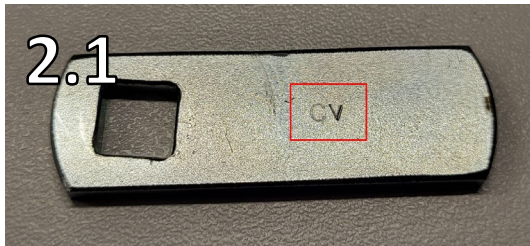

3. Secure the new cam with the screw (**image 3**). Operate the Elite Lock normally.

